

1/48



EVOLUTION

L-39C/ZO Albatros

eduard

11121 - NAV1

ATTENTION



UPOZORNĚNÍ



ACHTUNG



ATTENTION



注意



Carefully read instruction sheet before assembling. When you use glue or paint, do not use near open flame and use in well ventilated room. Keep out of reach of small children. Children must not be allowed to suck any part, or pull vinyl bag over the head.



Před započítím stavby si pečlivě prostudujte stavební návod. Při používání barev a lepidel pracujte v dobře větrané místnosti. Lepidla ani barvy nepoužívejte v blízkosti otevřeného ohně. Model není určen malým dětem, mohlo by dojít k požití drobných dílů.

INSTRUCTION SIGNS

INSTR. SYMBOLS

INSTRUKTION SINNBILDEN

SYMBOLES

記号の説明



OPTIONAL
VOLBA



BEND
OHNOU



OPEN HOLE
VYVRTAT OTVOR



SYMMETRICAL ASSEMBLY
SYMETRICKÁ MONTÁŽ



REMOVE
ODŘÍZNOUT



REVERSE SIDE
OTOČIT



APPLY EDUARD MASK
AND PAINT
POUŽÍTE EDUARD MASK
NABARVIT

PARTS



DÍLY



TEILE



PIÈCES



部品

PLASTIC PARTS

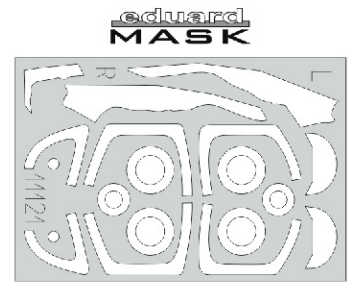
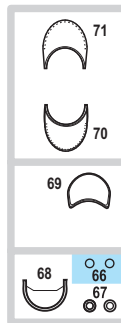
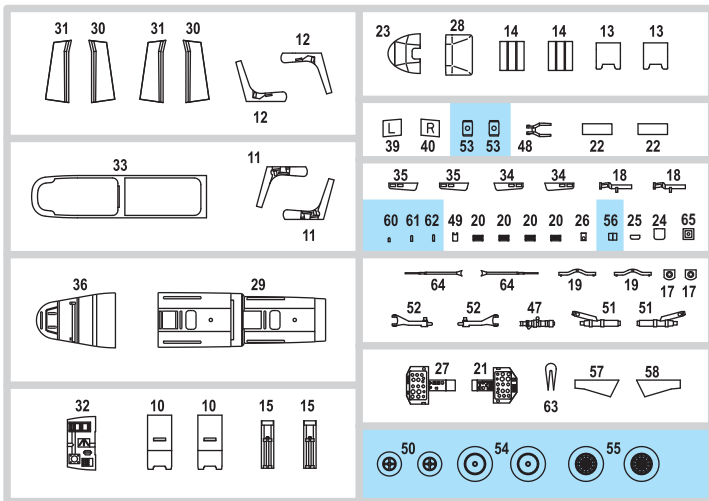
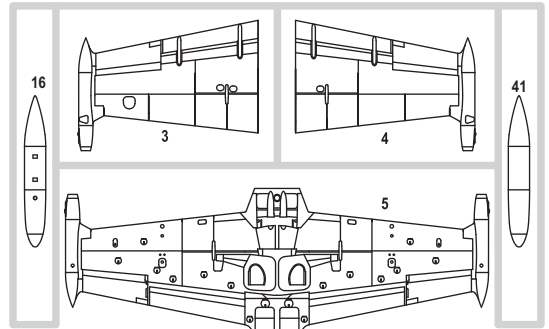
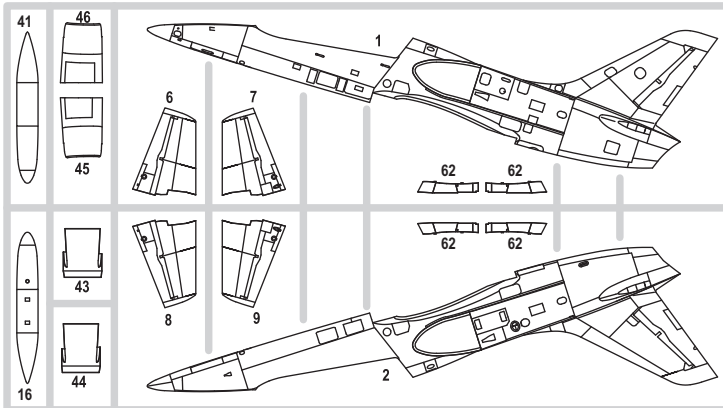

RP - RESIN PARTS

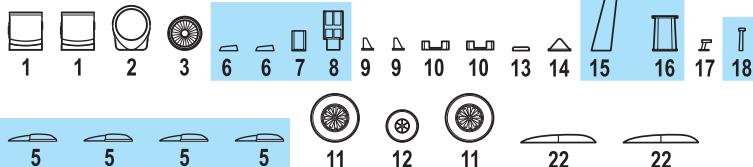

FILM

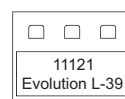

PE - PHOTO ETCHED DETAIL PARTS

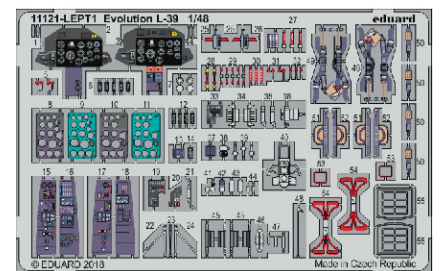

-Parts not for use. -Teile werden nicht verwendet. -Pièces à ne pas utiliser. -Tyto díly nepoužívejte při stavbě. - 使用しない部品

COLOURS



BARVY



FARBEN



PEINTURE



色

GSI Creos (GUNZE)		MISSION MODELS	
AQUEOUS	Mr.COLOR	PAINTS	
[H3]	C3	[MMP-003]	RED
[H6]	C6	[MMP-004]	GREEN
[H11]	C62	[MMP-001]	FLAT WHITE
[H12]	C33	[MMP-047]	FLAT BLACK
[H27]	C44		TAN
[H51]	C11	[MMP-063]	LIGHT GULL GRAY
[H56]	C366	[MMP-071]	INTERMEDIATE BLUE
[H76]	C61	[MMM-001]	BURNT IRON
[H77]	C137	[MMP-040]	TIRE BLACK
[H88]	C76		METALLIC BLUE
[H302]	C302		GREEN
[H307]	C307	[MMP-074]	GRAY
[H308]	C308	[MMP-073]	GRAY

GSI Creos (GUNZE)		MISSION MODELS	
AQUEOUS	Mr.COLOR	PAINTS	
[H310]	C310	[MMP-060]	BROWN
[H315]	C315	[MMP-069]	GRAY
[H317]	C317	[MMP-064]	GRAY
[H323]	C323		LIGHT BLUE
[H325]	C325	[MMP-063]	GRAY
[H405]	C126		OLIVE GREEN
	C34	[MMP-018]	SKY BLUE
	C66	[MMP-032]	BRIGHT GREEN
	C80	[MMP-093]	COBALT BLUE
Mr.METAL COLOR		METALLICS	
	[MC218]	[MMM-003]	ALUMINIUM
Mr.COLOR SUPER METALLIC		METALLICS	
	[SM01]	[MMC-001]	SUPER CHROME

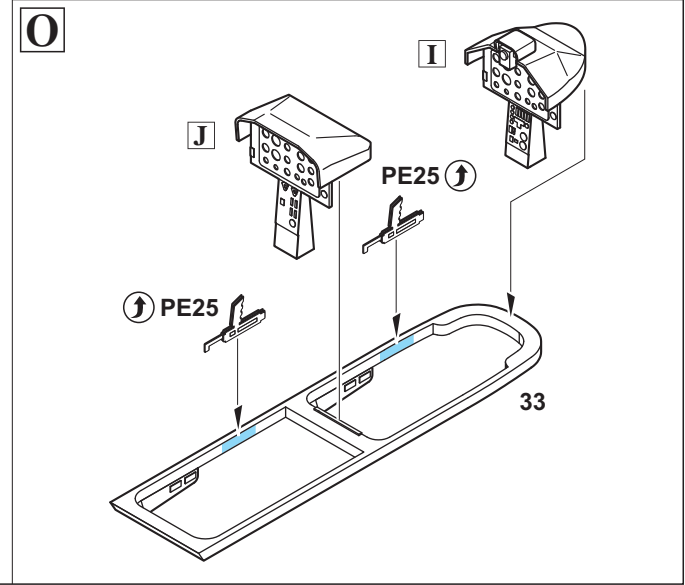
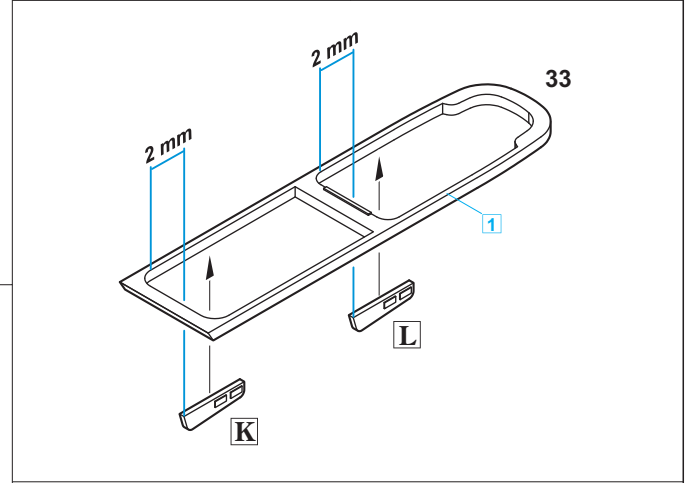
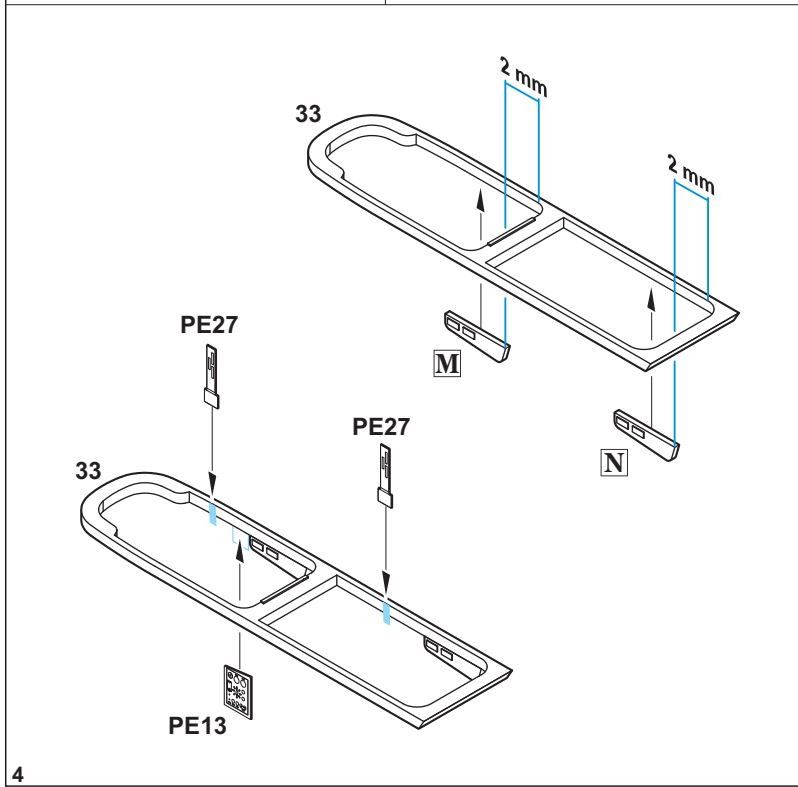
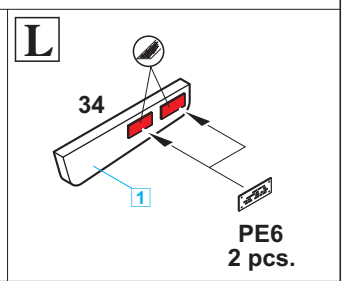
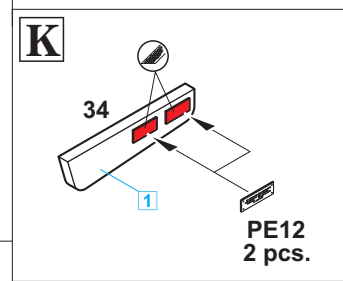
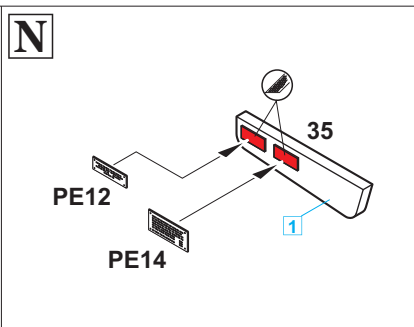
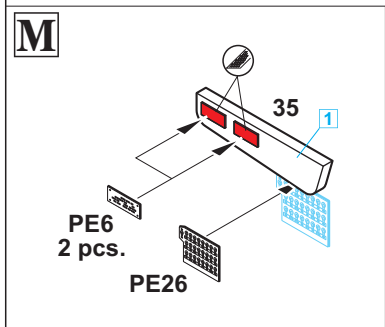
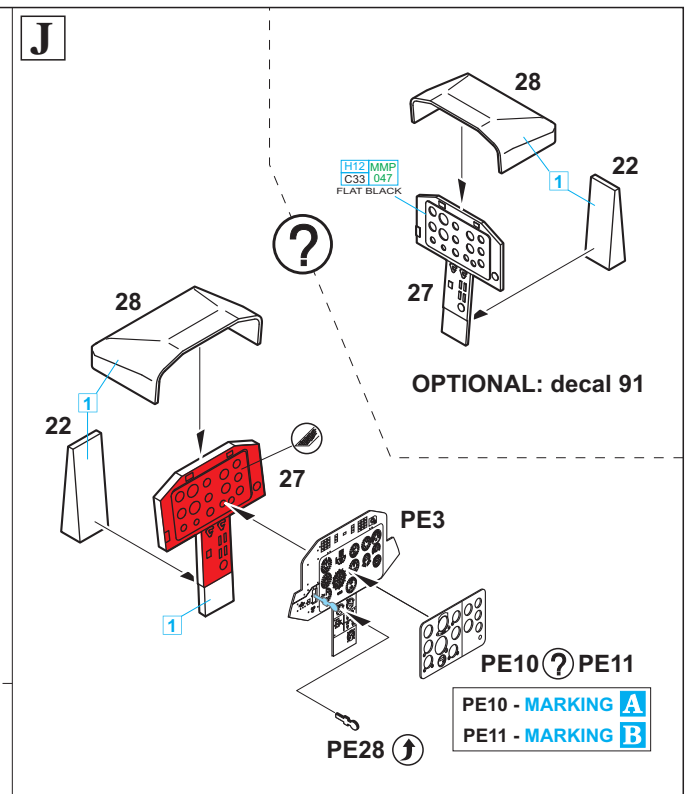
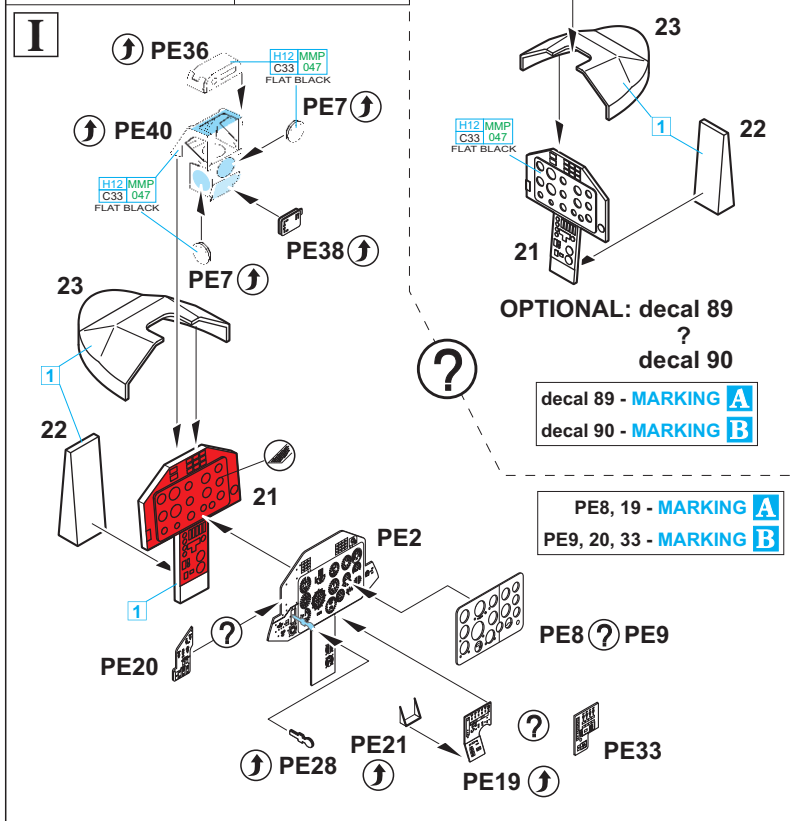
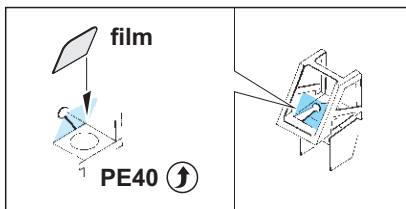

decal 53, 54 - MARKING B ONLY

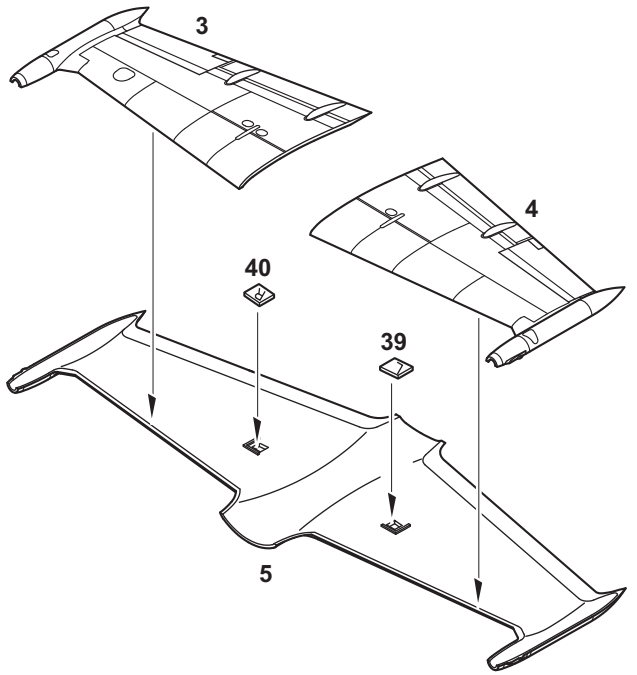
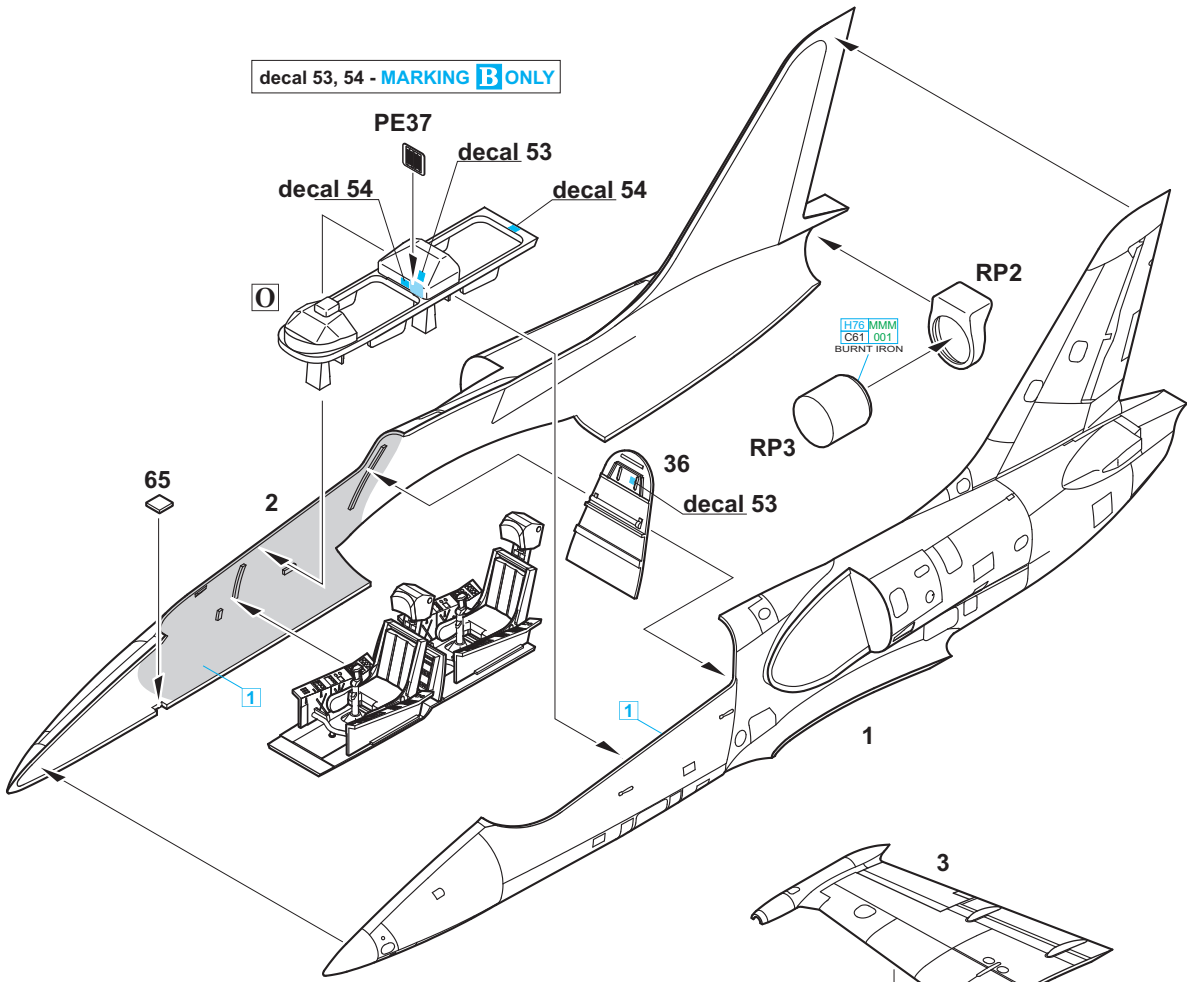

LIQUID MASK

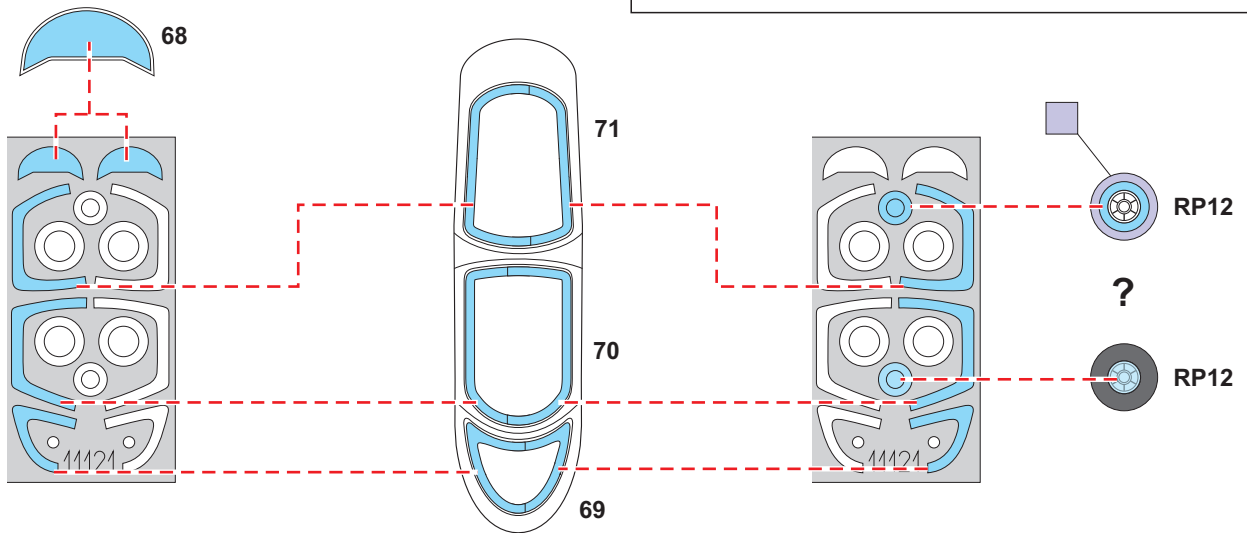
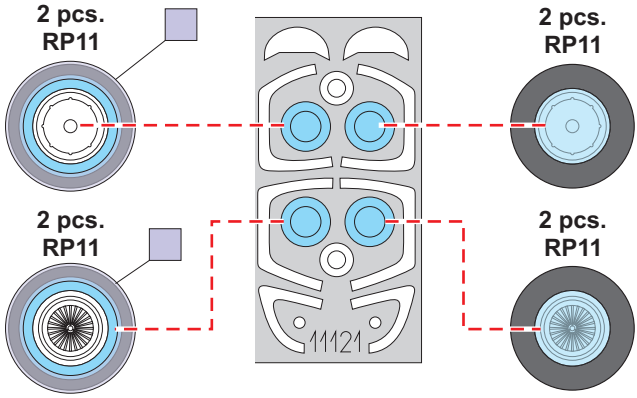

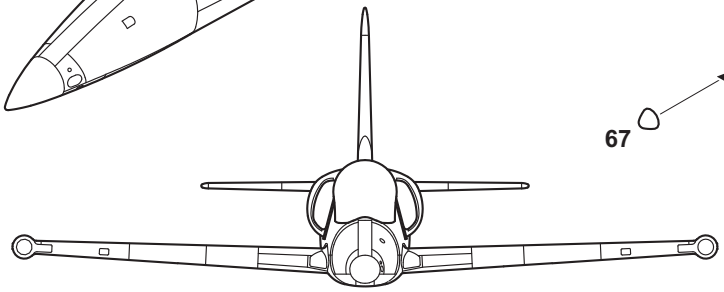
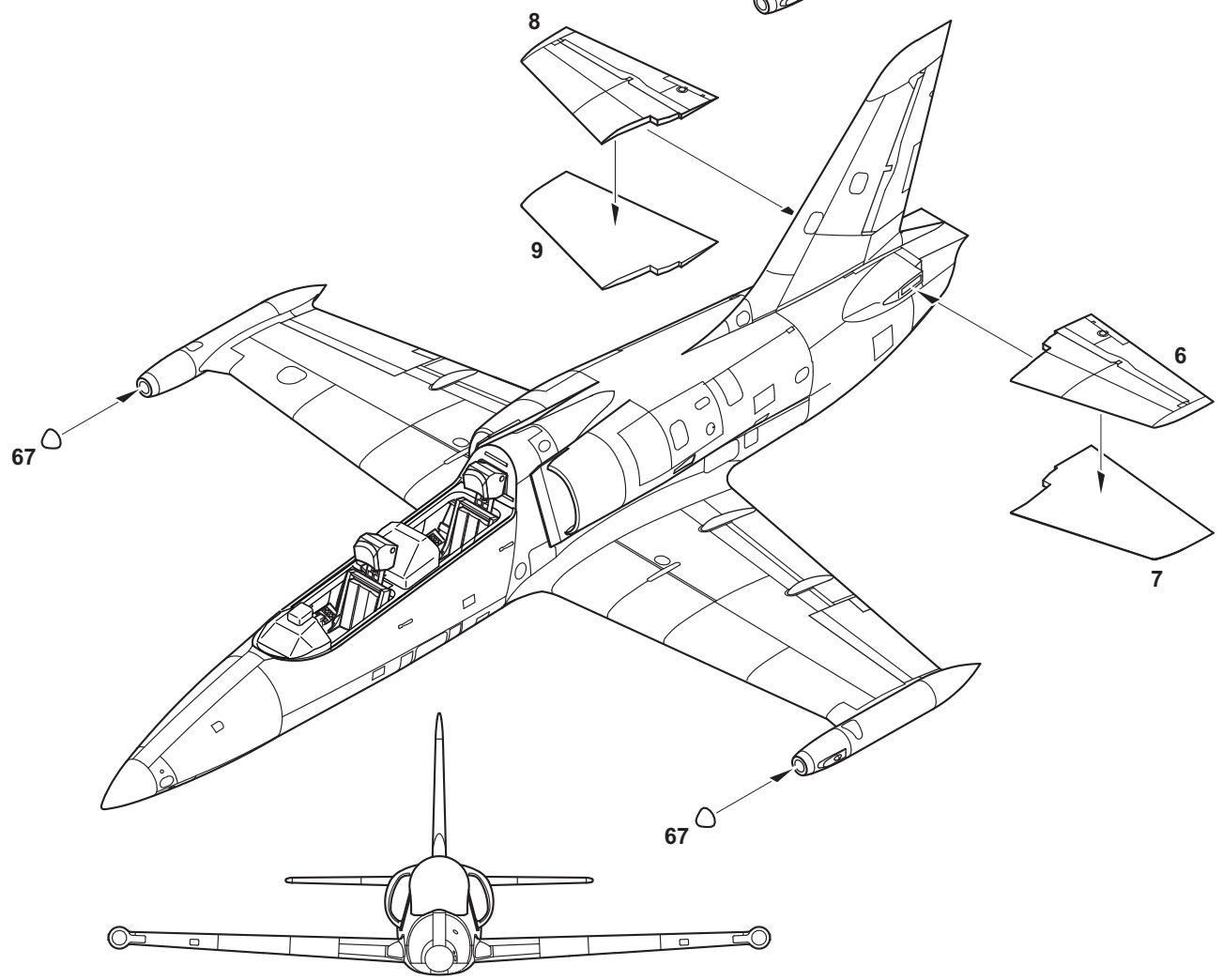
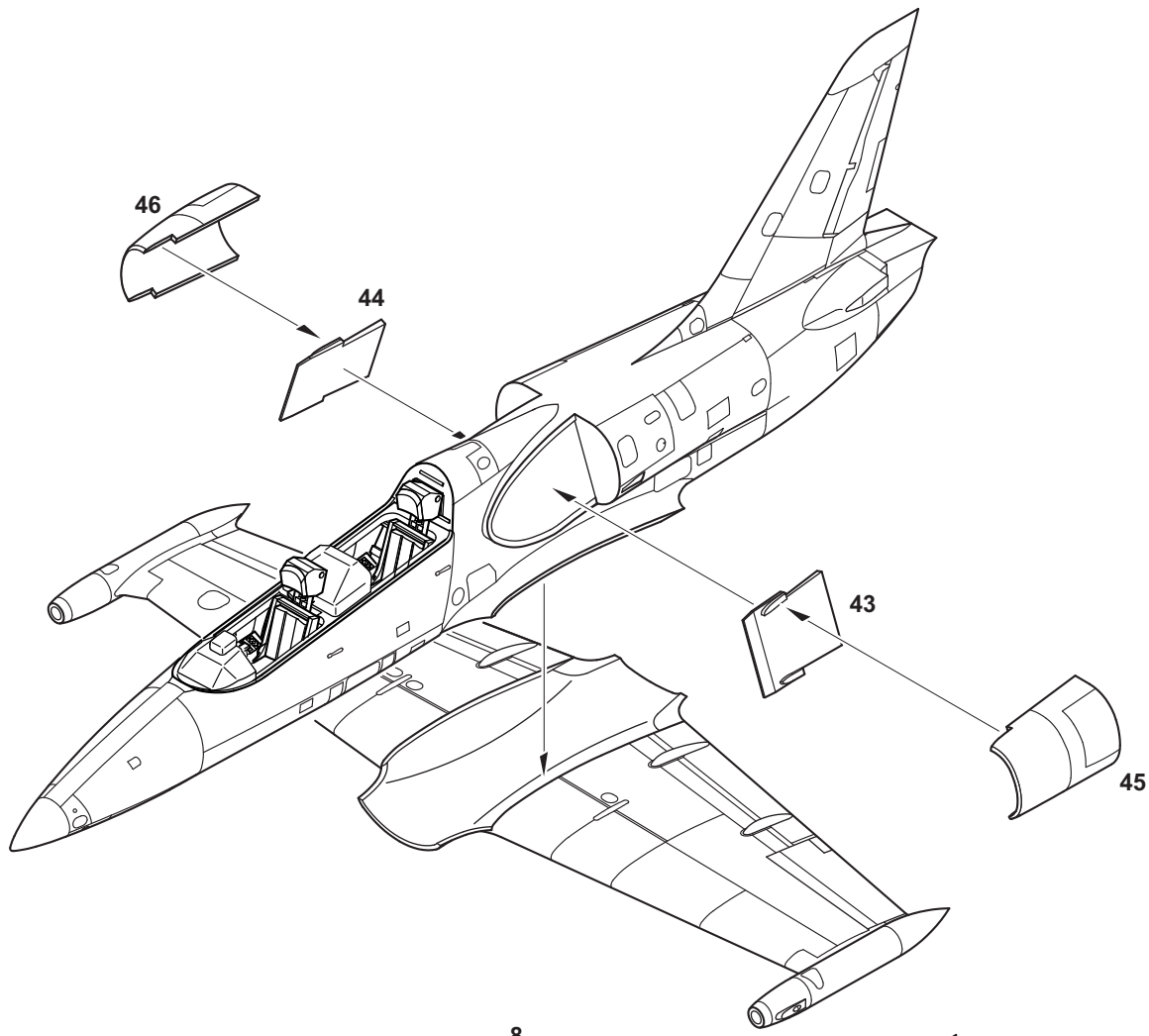

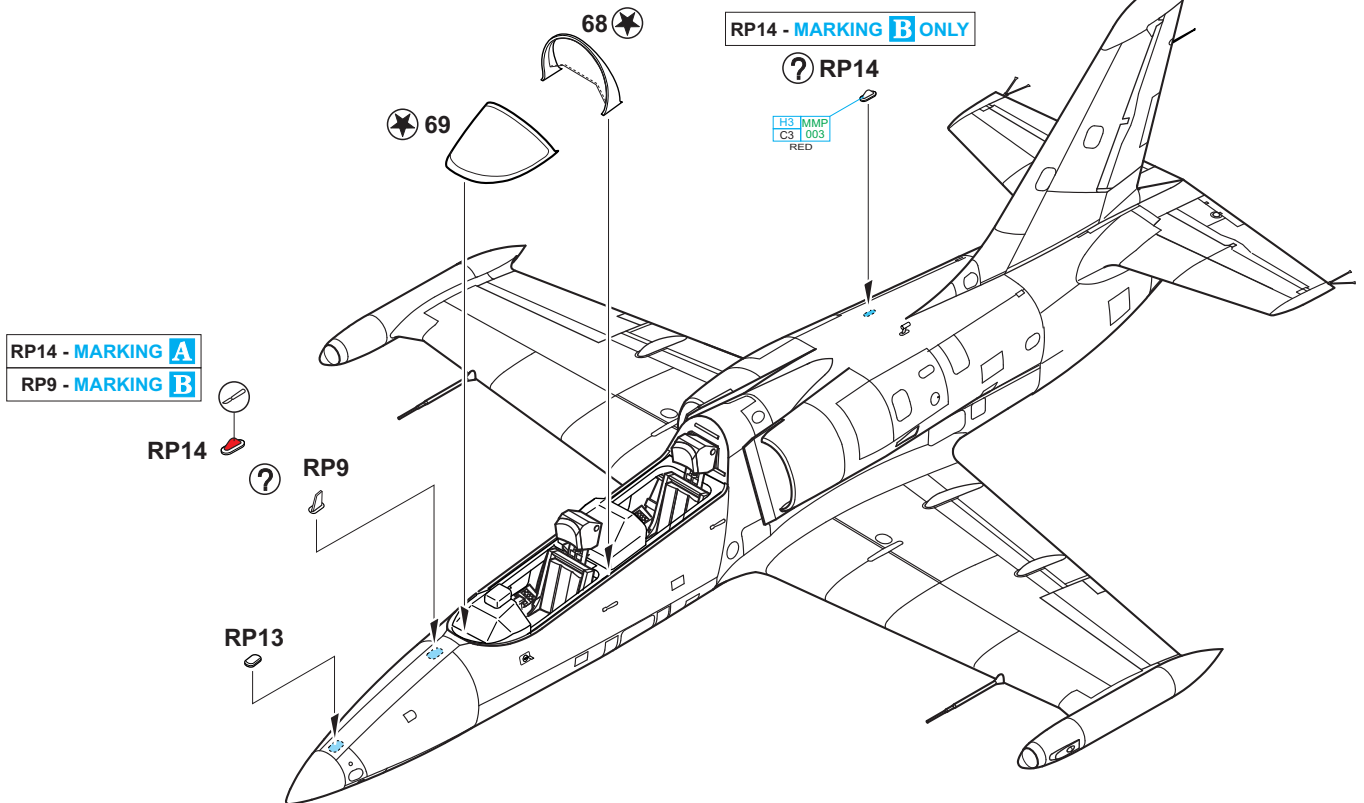
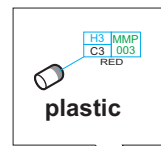
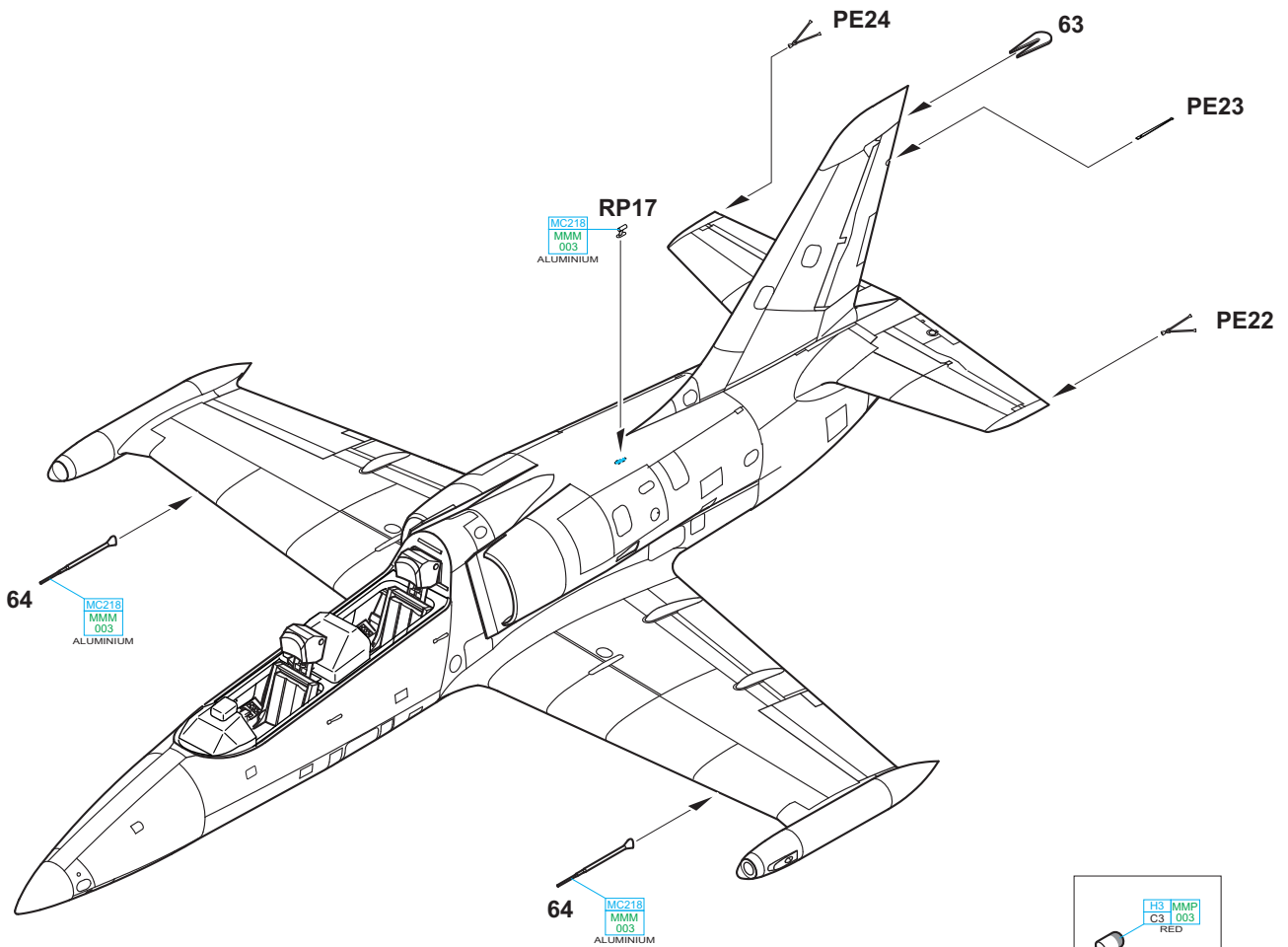

RP14 - MARKING A
RP9 - MARKING B

P

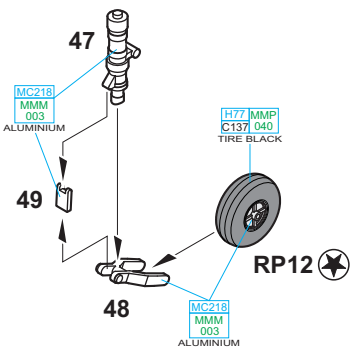

Q

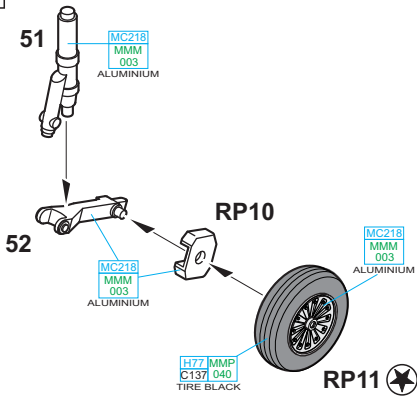

R

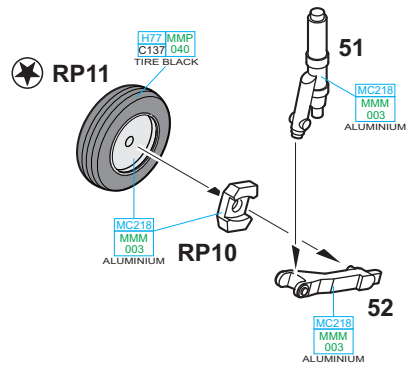

PE46, 47 - MARKING **B** ONLY

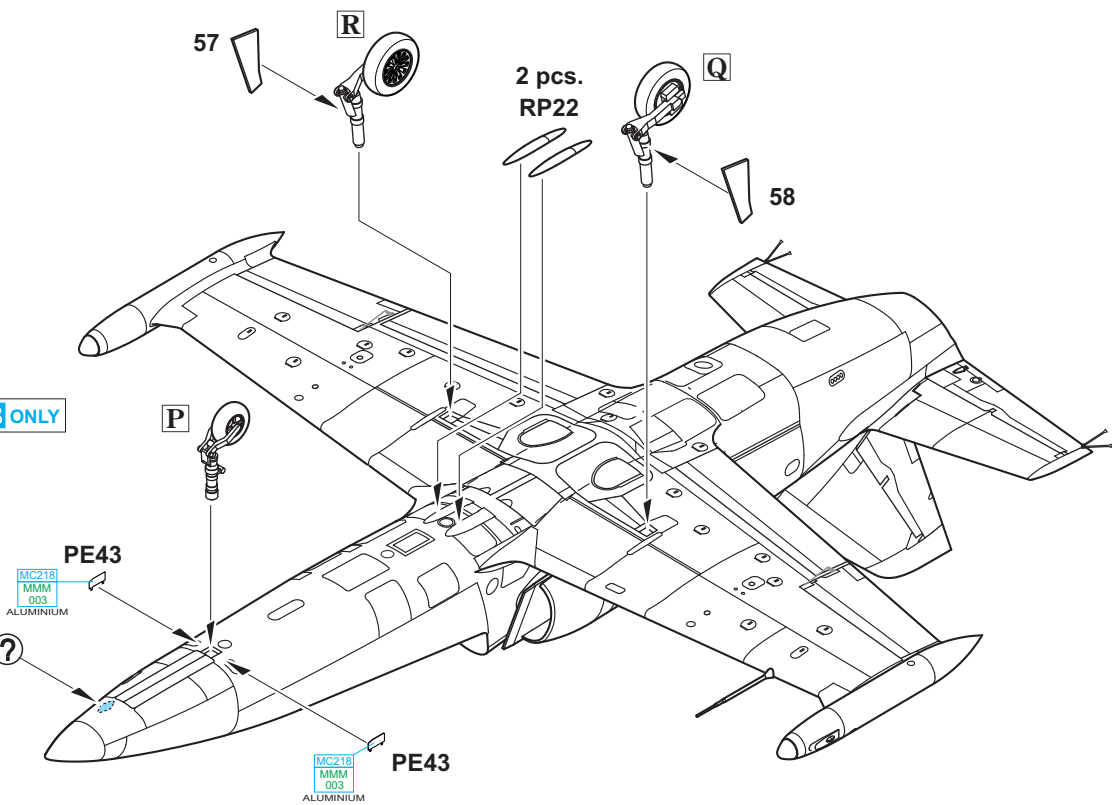
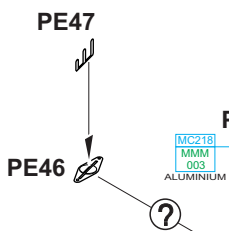

RP9 - MARKING **A** ONLY



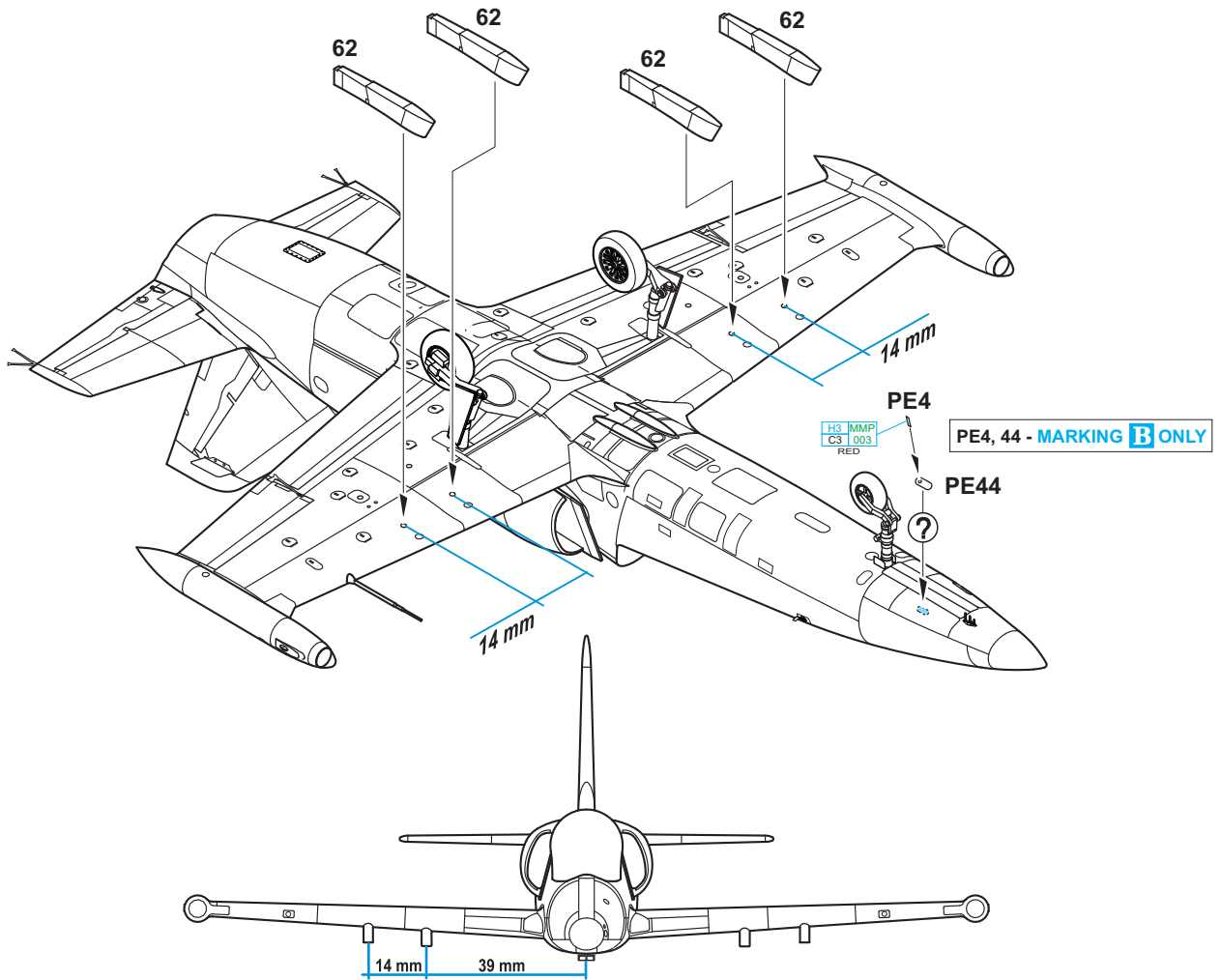

S 2 pcs.

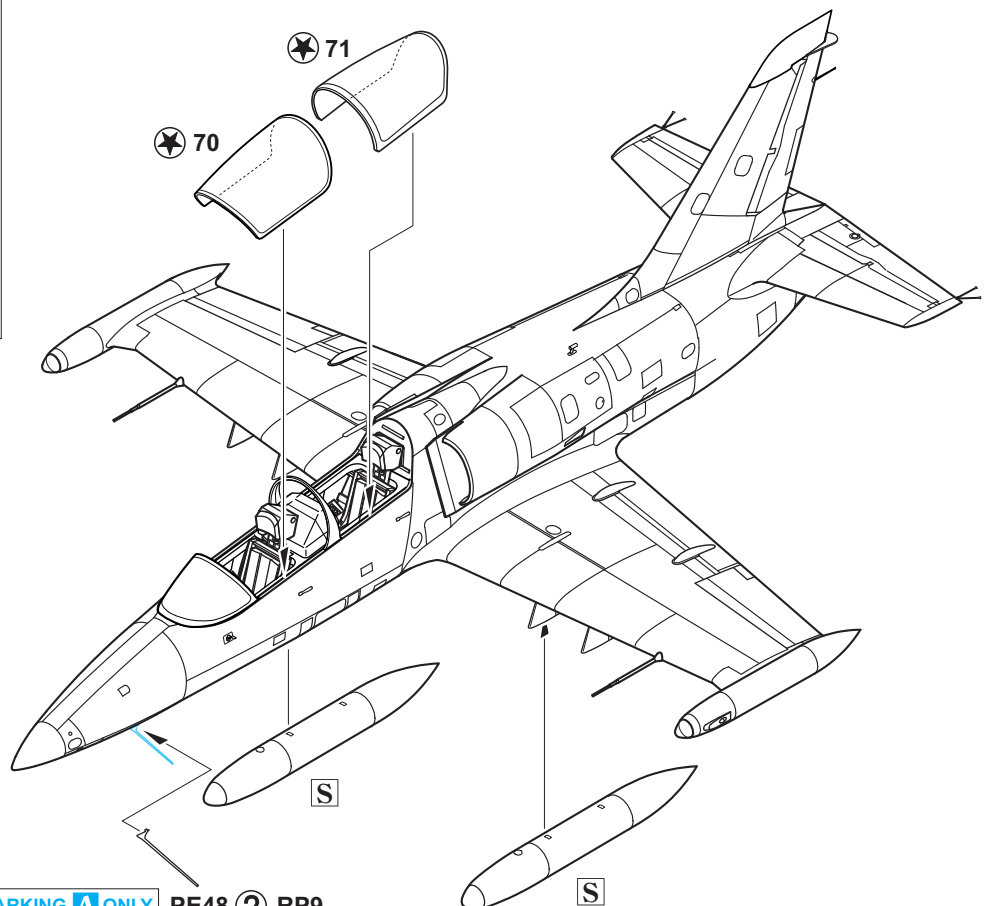
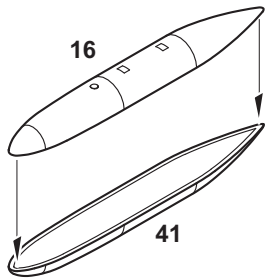

PE48 ? RP9 - MARKING A ONLY PE48 ? RP9

A L-39C, RA1039K, Aero Jet Club, letiště Mjačkovo, Moskva, Ruská federace, květen 2005

Mezi lety 1973 – 1991 obdržel Sovětský svaz celkem 2081 strojů verze C, jež sloužily k leteckému výcviku vojenských pilotů. Po rozpadu Sovětského svazu v roce 1991 zůstalo v Ruské federaci 1202 strojů, zbytek si rozdělily nově vzniklé státy. Jeden ze strojů byl zakoupen Aero Jet Clubem, sídlícím na letišti Mjačkovo. Zde létal s civilní registrací a dostal pestré zbarvení, doplněné o kresbu draka. S letounem prý létal také ruský prezident V. V. Putin.

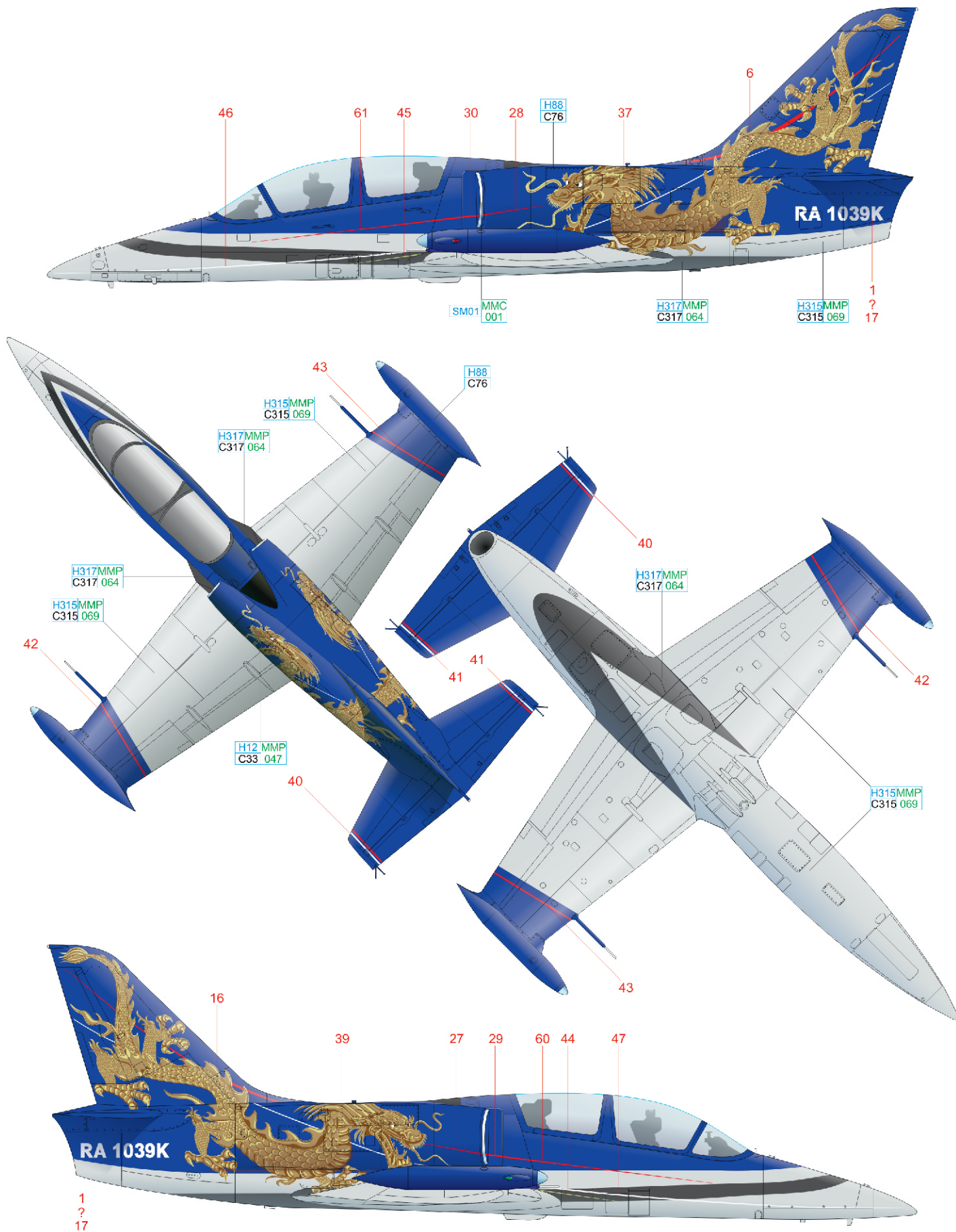

BLUE	H88 C76	LIGHT GRAY	H315MMP C315 069	BLACK	H12 MMP C33 047	DARK GRAY	H317MMP C317 064	SUPER CHROME	SM01	MMC 001
------	------------	---------------	---------------------	-------	--------------------	--------------	---------------------	-----------------	------	------------

eduard

